



Los Angeles Valley College



Campus Infrastructure - ADA Upgrades

Yang Management, Inc.

Cannon Constructors  West Edge Architects

DISTRICT-WIDE ADA STRATEGIES

Through Measure J Bond Program, the District is working with each campus to:

- Remove existing barriers to comply with 2010 California Building Code.
- U.S. Department of Justice 1991 ADA Standards.

Each Campus:

- Provide a campus wide survey of deficiencies.
- Create a transition plan to mitigate these non-compliant items.

Goal:

- Fully accessible and ADA compliant campuses.

PROJECT STATISTICS

Program: Upgrading non-compliant items campus wide, including:

- interior deficiencies
- exterior deficiencies
- Deficiencies within the scope of future bond projects will be mitigated as part of the future projects and are not included in this project.

Scope of Work:

Package #1: Art and Music Buildings.

Package #2: Foreign Languages, Behavioral Science, Humanities, and Engineering Buildings.

Package #3: Business/Journalism, Math/Science, and Life Sciences Buildings.

Package #4: North Gym, South Gym, and Campus Center Buildings.

Package #5: Update of ADA Masterplan and Path of Travel (POT) Improvements.

Package #6: Stadium.

Contract Amount: \$6.6 Million

Funding: Measure J

Schedule: Expected Design Completion:

June 2011.

Expected Construction Phase Completion:

November 2011.

Expected Close-Out Phase Completion:

January 2012.

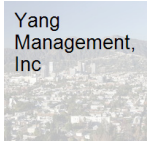

DESIGN STRATEGY

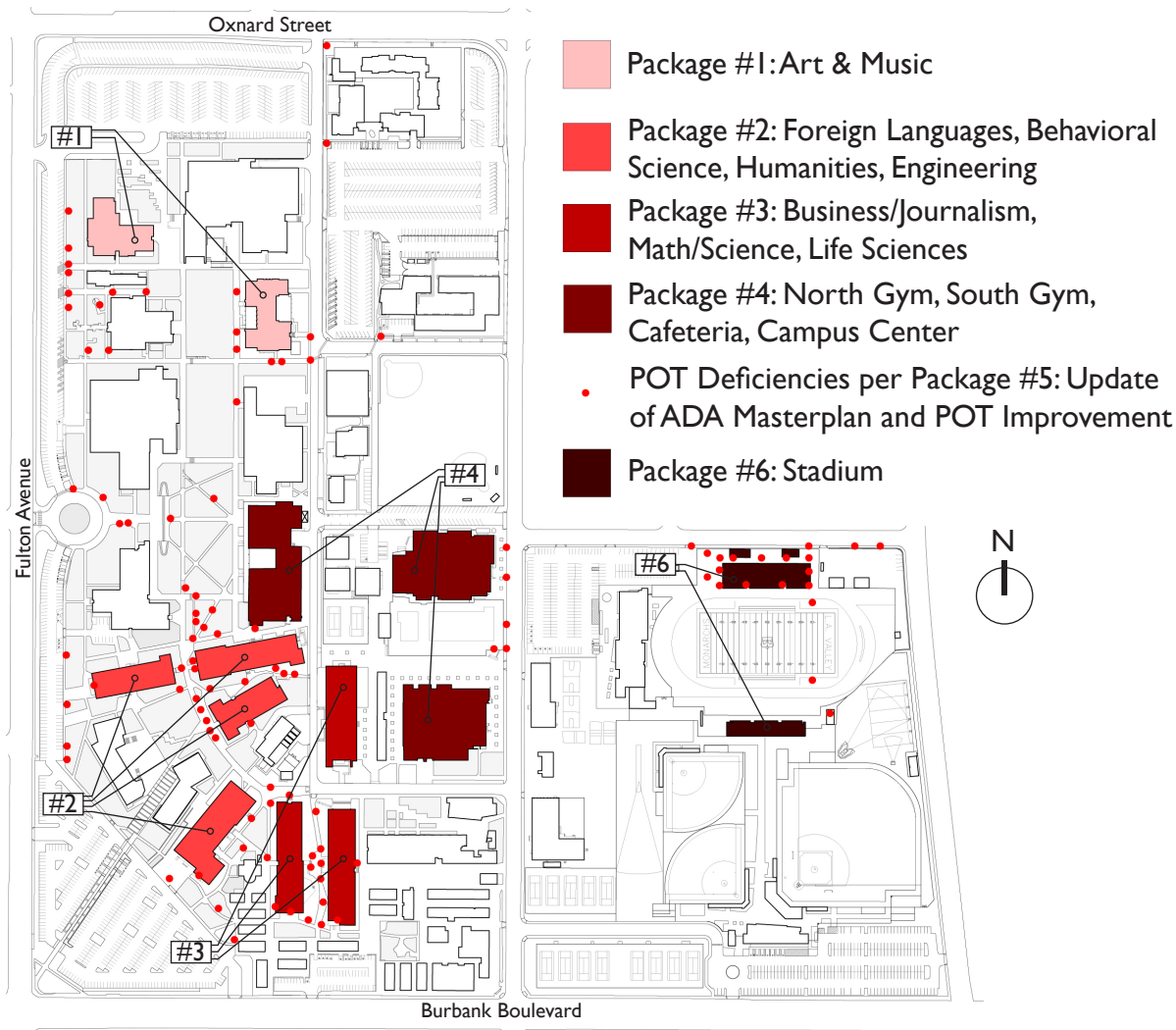

Scope of upgrades include:

- Signage
- Cabinetry
- Detectable Warnings
- Ramps
- Handrails
- Stair-Tread Striping
- Stadium Bleachers and Ramps
- Restrooms
- Classrooms
- Switch, Controls, and Electrical Outlet Height and Location Adjustment
- Leveling/Correcting Non-Compliant Floor Surfaces
- Adjustment/Replacement of Non-Compliant Doors
- Correcting Non-Compliant Clearances at Doors and Hallways

IDENTIFYING DEFICIENCIES

- Survey All Conditions

LOS ANGELES VALLEY COLLEGE- A.D.A. TRANSITION PLAN **BEHAVIORAL SCIENCE BUILDING - ROOM 100**

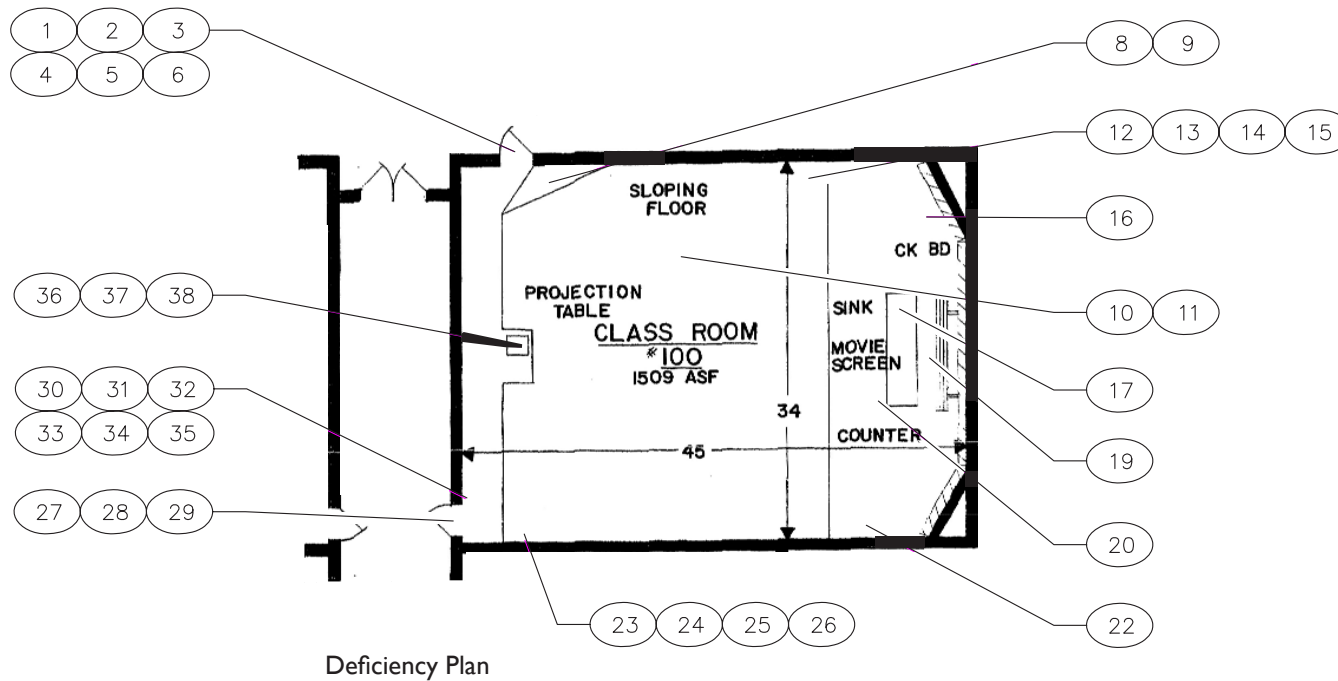

IDENTIFYING DEFICIENCIES

- Update and Expand Documentation

<p>Keynote 11</p>  <p>Location: Class Room 100</p> <p>Photo # 151</p>	<p>Field Condition</p> <p>14.24 - Fixed/Built-in Seating, Tables or Counters - At fixed or built-in seating, tables, or counters in public or general employee areas, less than 5% of the provided seating spaces are wheelchair accessible and have a 30" by 48" clear space which overlaps a POT. OR No seating spaces are wheelchair accessible.</p> <p>Existing Condition: No accessible wheelchair seating space.</p> <p>Corrective Action</p> <p>902 - Dining Surfaces and Work Surfaces - See Additional Comments</p> <p>Additional Comments: All 105 seats will be removed due to floor remodel (see keynote 12), and 99 reinstalled, replace six desks with ADA compliant models. Reinstall all to allow compliant aisle dimensions. Costs: Reinstall: 99 x \$250; Replace: 6 x \$500. Total Cost = \$28,750</p> <p>Costs and Funding</p> <table border="1"> <tr> <td>Qty ...Of:</td> <td>1 EA</td> </tr> <tr> <td>Total Cost</td> <td>\$27,750</td> </tr> <tr> <td>Funding Received</td> <td>\$0</td> </tr> </table> <p>Status Update (check one) Completed <input type="checkbox"/> In Progress <input type="checkbox"/> Not Complete <input type="checkbox"/></p>	Qty ...Of:	1 EA	Total Cost	\$27,750	Funding Received	\$0
Qty ...Of:	1 EA						
Total Cost	\$27,750						
Funding Received	\$0						

Photo Survey



EXAMPLE OF IMPROVEMENTS

Behavioral Science Classrooms 100 & 101:

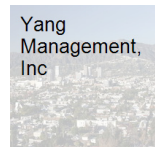
1. Increase level floor area at entry doors.
2. Provide sloped floor with maximum 8.33% slope.
3. Provide staggered fixed seating.
4. Provide 4 wheelchair accessible spaces.
5. Install new compliant handrails.
6. Replace existing teaching station with accessible furnished unit per LAVC standards.

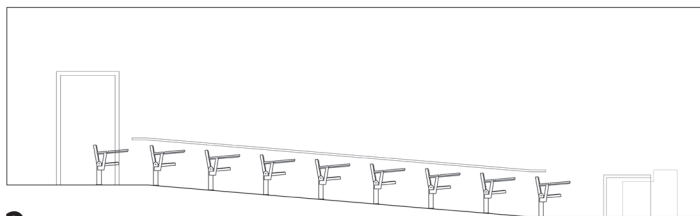

2 SECTION

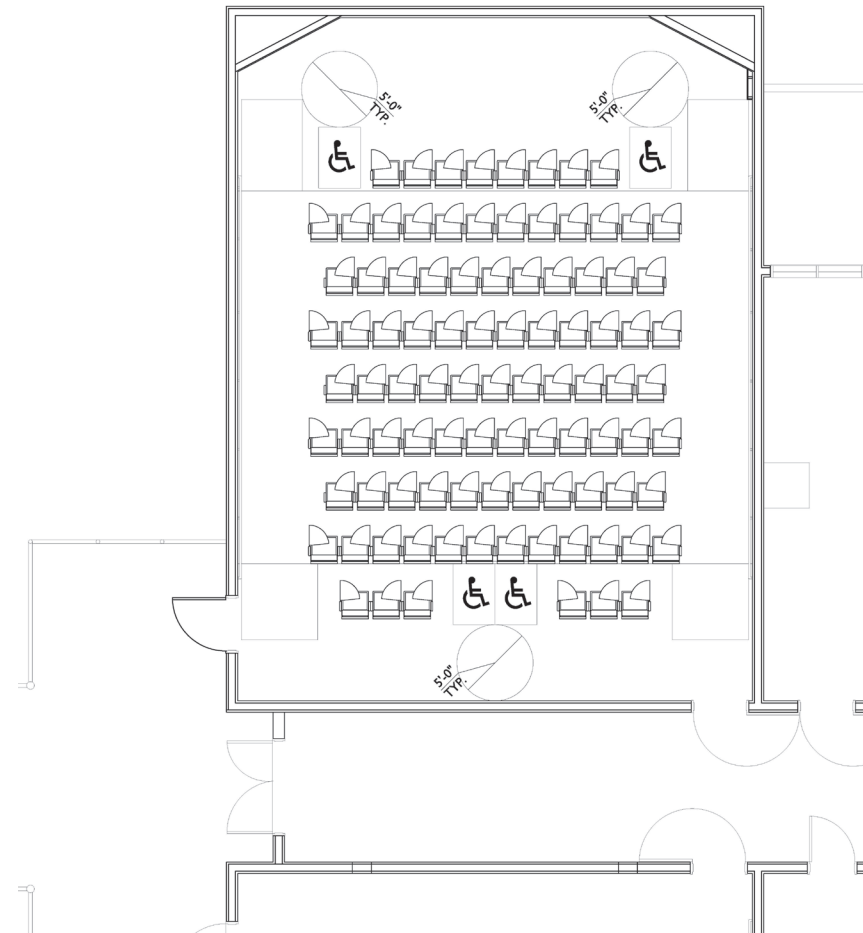

1 FLOOR PLAN

2012 CAMPUS PEDESTRIAN PATH OF TRAVEL

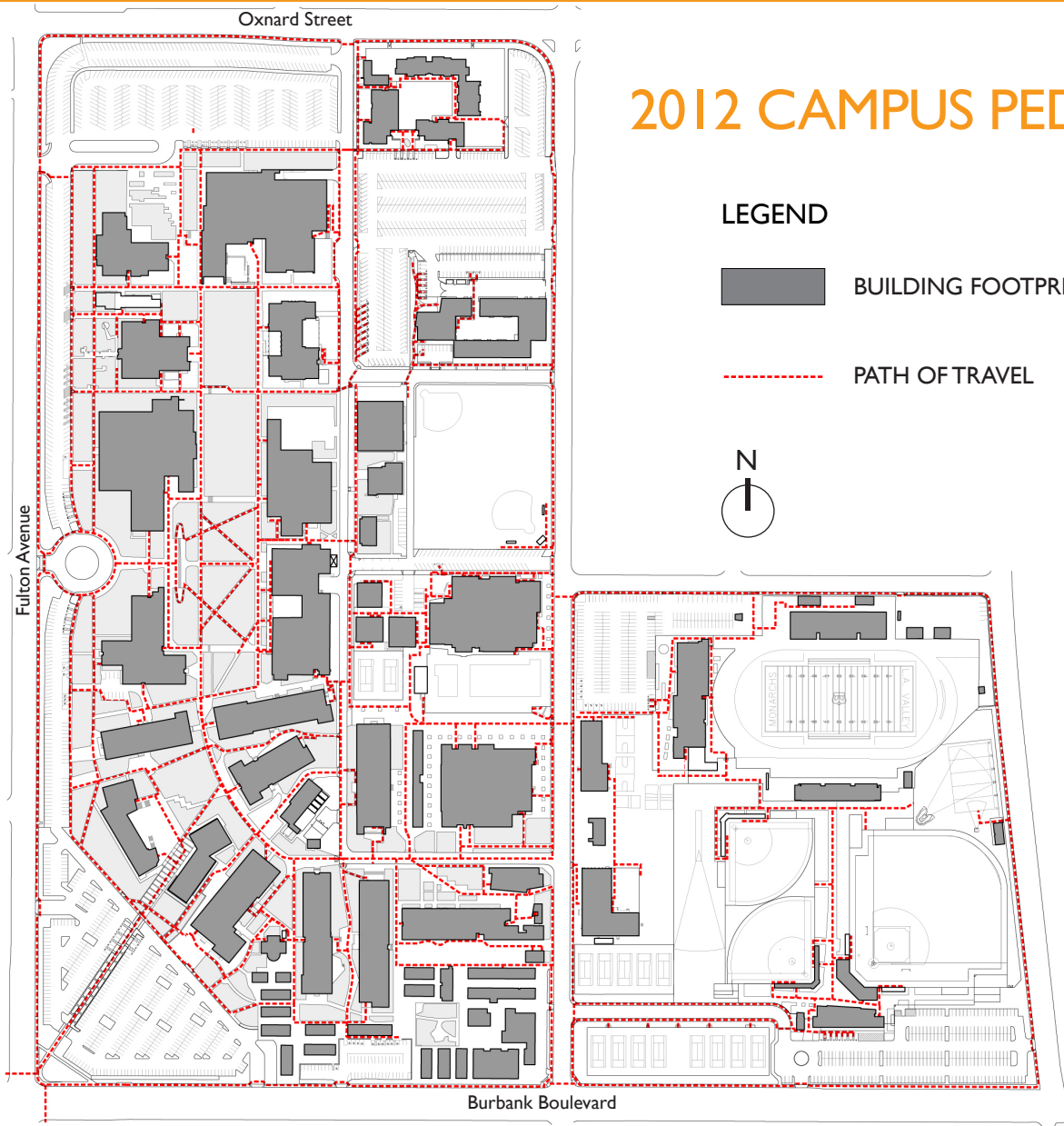



Los Angeles Valley College



Campus Infrastructure - ADA Upgrades

Yang Management, Inc.

Cannon Constructors  West Edge Architects